

CENTRIFUGAL PUMP

*Suitable for conveying water or other liquids
with similar properties to water without abrasive particles.*



INDUSTRIAL WATER



CITY WATER SUPPLY



GARDEN IRRIGATION



1-5CPM100S VERSION K1

CENTRIFUGAL PUMP

ZHEJIANG GRANDFAR PUMP INDUSTRY CO., LTD
E-MAIL: INFO@GRANDFARGROUP.COM



Product
Info





1-5CPm100S

CENTRIFUGAL PUMP

VERSION K1

CENTRIFUGAL PUMP

1-5CPm100S series centrifugal pump is Widely used in agricultural irrigation, sprinkler irrigation, garden sprinkler irrigation, vegetable greenhouse water supply and aquaculture water supply and drainage, as well as well water lifting. Tap water pressurization and other domestic water occasions.



Model instruction

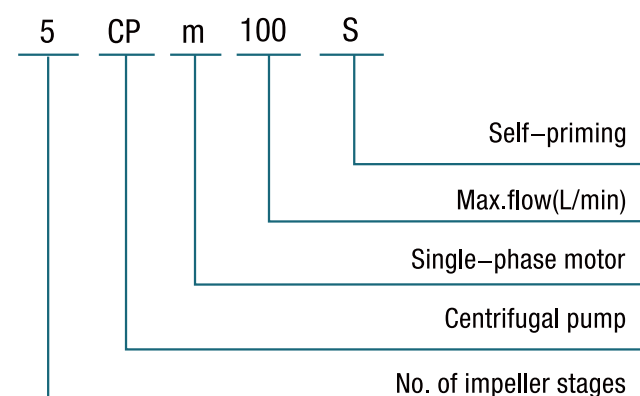

Pump configuration

- Casing and coupling: Cast iron , electrophore tictreatment;
- Impeller: PPO;
- Guide vane: PPO;
- Self-priming disk: PPO;
- Motor shaft: 304 Stainless steel;
- Pump casing: 304 Stainless steel;

Pump Features

- Copper wire motor with built-in thermal protector;
- Compact structure, Simple and easy installation;
- High water output and stable operation;
- Water pump adopts multi-stage impeller structure design, Multi-stage structure is more suitable for high pressure water working environment

Application Limits

- The PH value of the medium is between 6.5-8.5;
- The volume ratio of solid impurities does not exceed 0.1%, The particle diameter is not more than 0.2mm;
- When the temperature is lower than 0 °C, antifreeze work should be done.

TECHNICAL SPECIFICATIONS

Max.Power	Max.Flow	Max.Head	Max working pressure	Liquid temperature	Suct.Max.
Up to 0.9 kW	6 m ³ /h	50 m	0.5 MPa	Up to 40°C	8 m

PERFORMANCE CHART

Model	Power	Max.head	Max.flow	Size	Suct.Max.	N.W	G.W	Dimension LxWxH(cm)
	kW	m	m ³ /h	Inch	m	kg	kg	
1CPm100S	0.25	11	4.2	1"×1"	3	7.3	8.4	37x17.5x20.8
2CPm100S	0.37	20.6	5	1"×1"	8	8.1	9.1	39.5x17.5x20.8
3CPm100S	0.6	32	5.5	1"×1"	8	8.8	9.8	42x17.5x20.8
4CPm100S	0.75	42	6	1"×1"	8	9.7	10.7	46.5x17.5x20.8
5CPm100S	0.9	50	6	1"×1"	8	10.4	11.5	49x17.5x20.8

PERFORMANCE CURVE

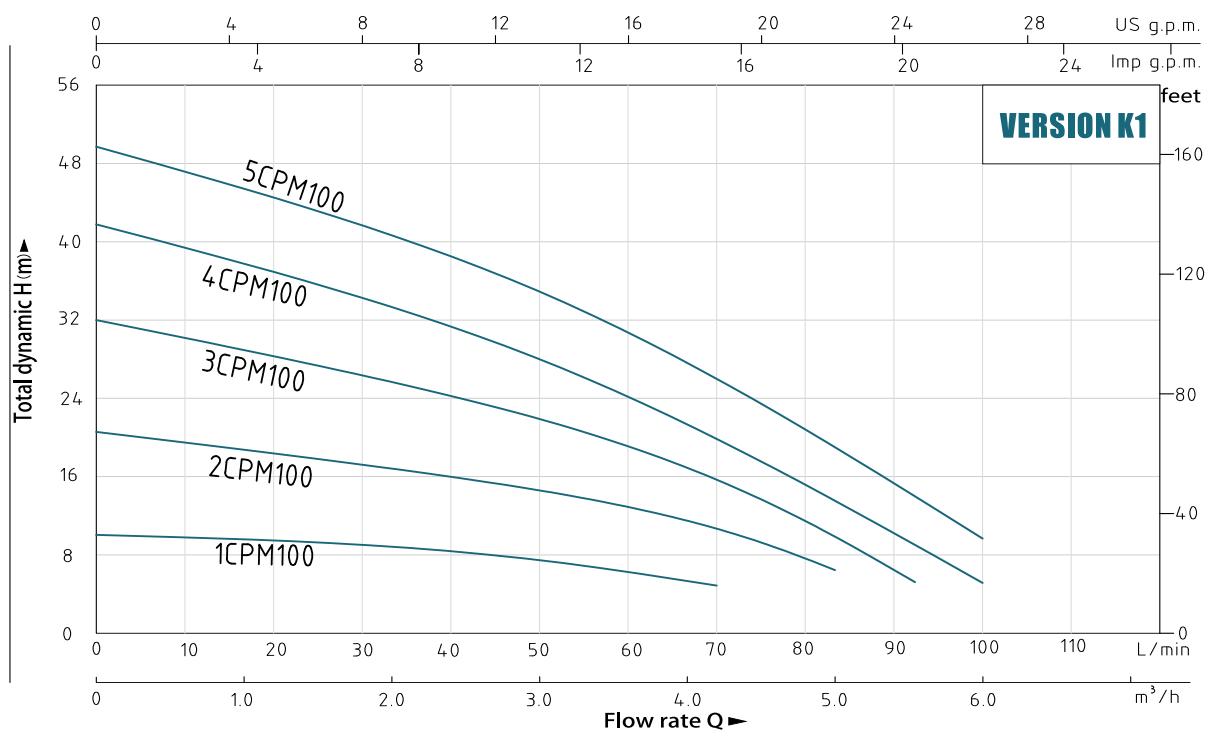

PRODUCT DIMENSIONS

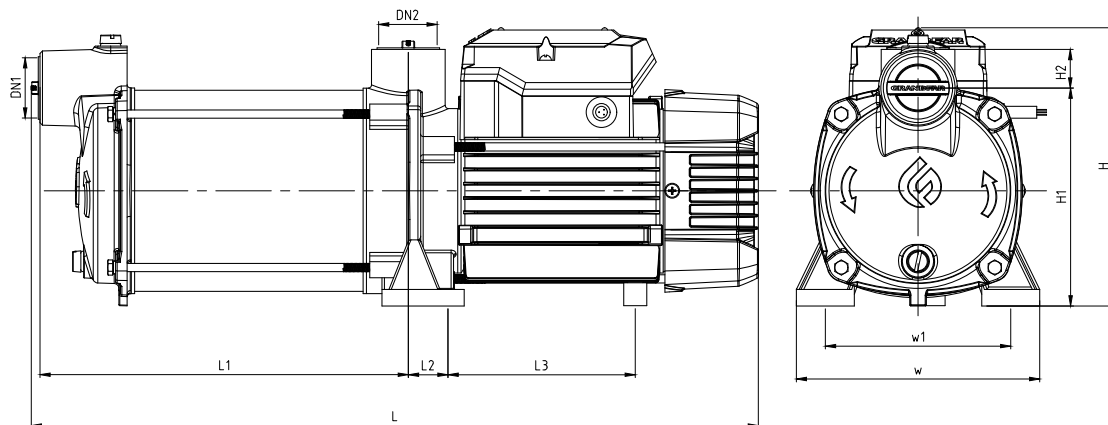

Model	Dimension(mm)										
	DN1	DN2	L	W	H	L1	L2	L3	W1	H1	H2
1CPm100S	1"	1"	349.5	148	169.5	146	24	99	115	132.5	23.5
2CPm100S	1"	1"	375.5	148	169.5	172	24	99	115	132.5	23.5
3CPm100S	1"	1"	401.5	148	169.5	198	24	99	115	132.5	23.5
4CPm100S	1"	1"	442.5	148	169.5	224	24	114	115	132.5	23.5
5CPm100S	1"	1"	468.5	148	169.5	250	24	114	115	132.5	23.5

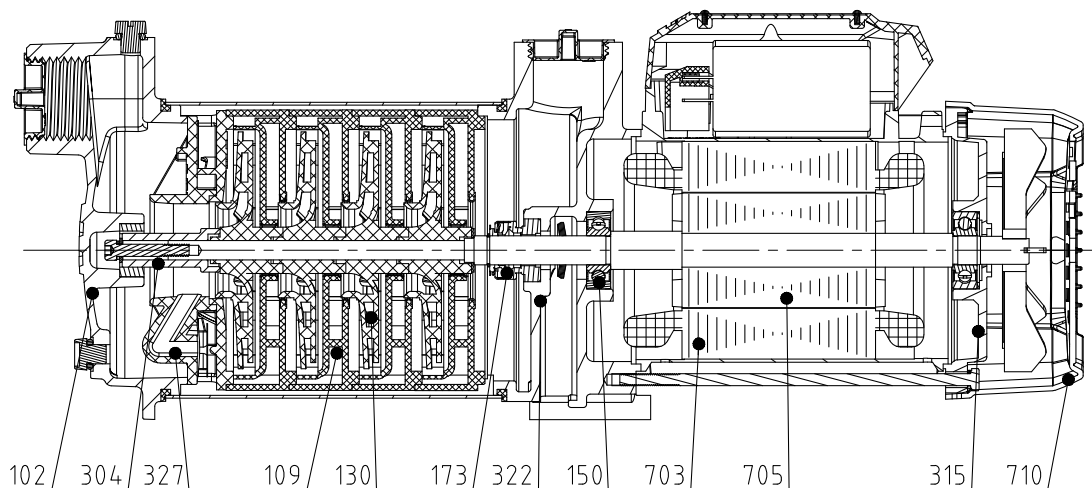
PRODUCT CONFIGURATION
VERSION K1

POS.	COMPONENT	CONSTRUCTION CHARACTERISTICS
102	CASING	Cast iron surface electrophoresis treatment
109	GUIDE VANE	PPO plastic
130	IMPELLER	PPO plastic
150	BEARING	C & U
173	MECHANICAL SEAL	Ceramic - graphite
304	SHAFT SLEEVE	304 stainless steel
315	END COVER	Aluminum
322	COUPLING	Cast iron surface electrophoresis treatment
327	SELF-PRIMING DISK	PPO plastic
703	STATOR CORE	Stator core with winding
705	ROTOR	Cast aluminum rotor
710	FAN COVER	Plastic

MISSION

To create value for customers and to make life better through our products and services

VISION

To provide sustainable smart products globally and become a leading brand owner of water pumps and tools

VALUE

Integrity Innovation Enhancement Win-Win

